

540AKR

COMPLETE 3" Flush Valve & Flapper Repair Kit

All you need to replace a
3" Flush Valve for today's
High Efficiency Toilet (HET)

Fits most Toto®, American Standard®
and other 3" flapper toilets

**Restore your toilet to original
performance with the 3" Flush
Valve, by Fluidmaster.**

Special features:

- Easily adjustable overflow tube
- Adjustable flapper to maximize water savings
- Complete Kit with all the parts you need including a tank to bowl gasket, no rust brass bolts, washers and nuts



Save Water!
Improve
Performance!

540AKR
**COMPLETE
 3" Flush Valve &
 Flapper Repair Kit**

Easily adjustable overflow
 tube can be set to meet
 OEM specifications

Kink-free chain

Long lasting, chlorine
 resistant silicone seal

Adjustable flapper:
 Optimizes water
 savings and
 performance

Kit includes
 everything you
 will need – tank to
 bowl gasket, no
 rust brass bolts,
 washers, and nuts



**Adjustable to fit most
 3" flapper toilets**

**All you need
 in one kit**

**Saves water and
 restores performance**

**Preferred by toilet
 manufacturers**

**QUICK, EASY
 INSTALLATIO**

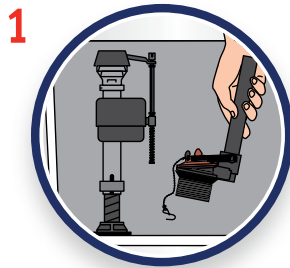

Remove.

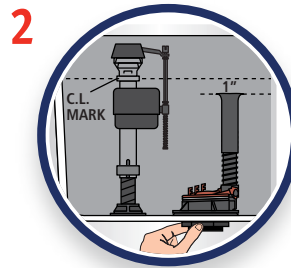

Set Adjustable Overflow Tube.

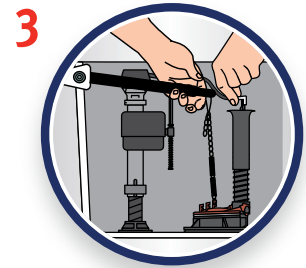

Connect.

MODEL NUMBER	CASE QTY	PRODUCT DIMENSIONS H/W/D (INCHES)	CASE DIMENSIONS H/W/D (INCHES)	CASE WEIGHT (LBS)	UPC	SCCI 2of5
540AKR	5	6.00" x 4.50" x 7.42"	23.75" x 6.50" x 9.44"	6.15 lbs	0 39961 30034 8	100 39961 08358 3