

APPROVAL LOGO



Product Name: 400A
 Product #: FM400A

TOOLS NEEDED:



DO NOT USE:

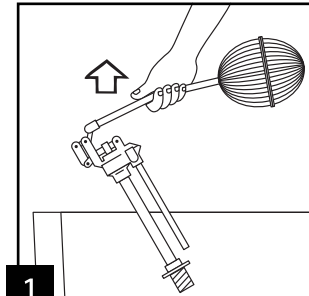

1.

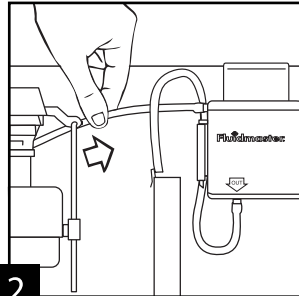

2.

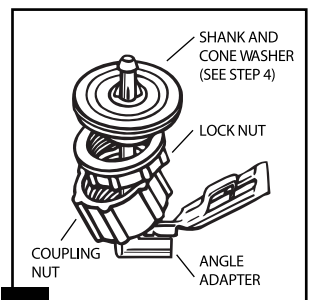

3.

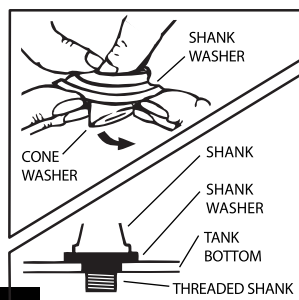

4.

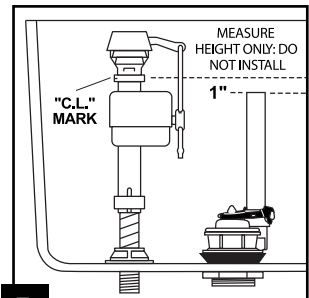

5.

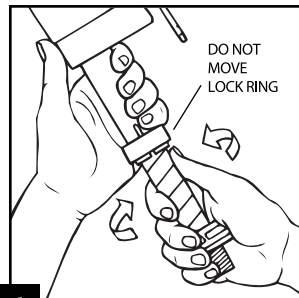

6.

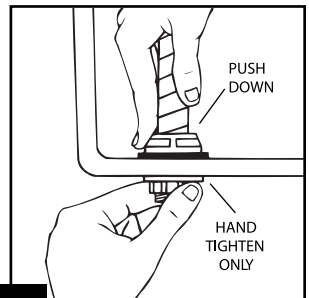

7.

WARNING



DO NOT USE IN-TANK DROP-IN TOILET BOWL CLEANERS CONTAINING BLEACH OR CHLORINE. Use of such products will: (1) RESULT IN DAMAGE to tank components and MAY CAUSE FLOODING and PROPERTY DAMAGE and (2) VOID WARRANTY. DO NOT overtighten nuts or tank/bowl may crack.

Fluidmaster Flush 'n' Sparkle™ Toilet Bowl Cleaning System is recommended for those choosing to use in-tank bowl cleaners and WILL NOT VOID the FLUIDMASTER WARRANTY because it will not damage tank components.

- Shut off water supply to tank. Flush tank and sponge out remaining water. Remove old fill valve assembly using pliers if necessary.
- If you have a Fluidmaster bowl cleaning system, carefully disconnect the tube from the fill valve. Do not disconnect the tube from the dispenser (if you don't have a cleaning system, continue to Step 3).
- Disassemble small parts—LOCK NUT, SHANK WASHER and ANGLE ADAPTER for Valve installation (required); CONE WASHER and COUPLING NUT for Water Supply Connection (optional—see Step 8).
- Carefully remove CONE WASHER from center of SHANK WASHER. Place SHANK WASHER on threaded shank of new VALVE. Place flat surface against valve.
- When installed, the critical level mark on the fill valve (identified by a C.L. mark on the Fluidmaster Fill Valve) should be at least 1" above the top of the overflow pipe. This is a plumbing code.
- To adjust the height of the fill valve, twist the threaded shank in or out of valve body. The height of the valve adjusts from 9 to 14 inches. On some models, a clicking noise will be heard when adjusting the height. This is normal.
- Position valve inside tank. Push down on the valve shank (not the top) while tightening lock nut. Hand tighten only. DO NOT OVERTIGHTEN or tank may crack. Make sure float cup does not touch toilet tank walls, trip mechanism or flush valve.
- Before continuing, determine the type of water supply connection you have from the chart on the left and use the appropriate assembly parts required to properly reconnect the water supply. DO NOT use plumber's putty to seal these fittings.

	METAL/COPPER FLARED TUBING	METAL FLANGED TUBING	METAL SPIRAL TUBING	VINYL/BRAIDED CONNECTOR
<p>DO NOT use plumber's putty to seal these fittings.</p> <p>These parts must be used as illustrated to insure watertight connection. Use of existing coupling nut or cone washer may result in water leakage. Water supply tube or pipe must extend at least 1/2" inside threaded shank of valve (does not apply to flanged tubing).</p>				
	Use existing coupling nut and washer	Use existing spiral cone washer. Fluidmaster cone washer may not seal completely on spiral type supply line.	Captive cone washers already included. No additional washers needed.	
<p>CAUTION: DO NOT USE CONE WASHER WITH PLASTIC SUPPLY LINE.</p>	<p>CAUTION: Overtightening of LOCK NUT or COUPLING NUT could result in breakage and potential flooding.</p>			